

# BALL VALVES - MULTIWAY AND DEADMAN

SHORT VERSION

[Click here](#) for complete version of this catalogue

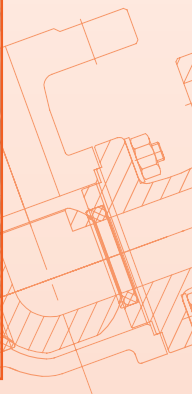
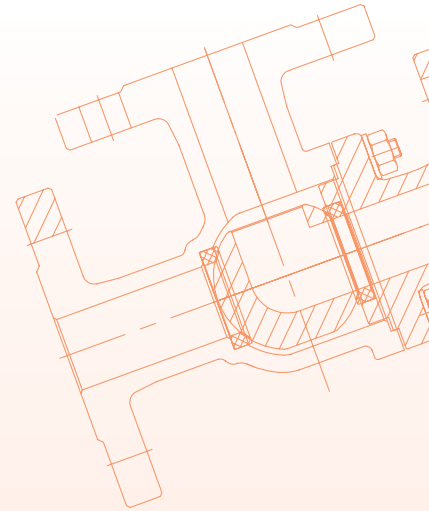

**AUSTRALIAN  
PIPELINE VALVE®**

[www.australianpipelinevalve.com.au](http://www.australianpipelinevalve.com.au)

# QUALITY VALVE MANUFACTURER

## QUALITY COMMITMENT

*Quality is Our First Priority.*

*Consistent product quality and a proven track record makes Australian Pipeline Valve a dependable choice where total reliability is the number one concern.*

*Since its founding, APV's philosophy has been focused on quality. Our valves are manufactured in full compliance to worldwide standards (such as ASME/ANSI, API, EN, ISO, BS, AS).*

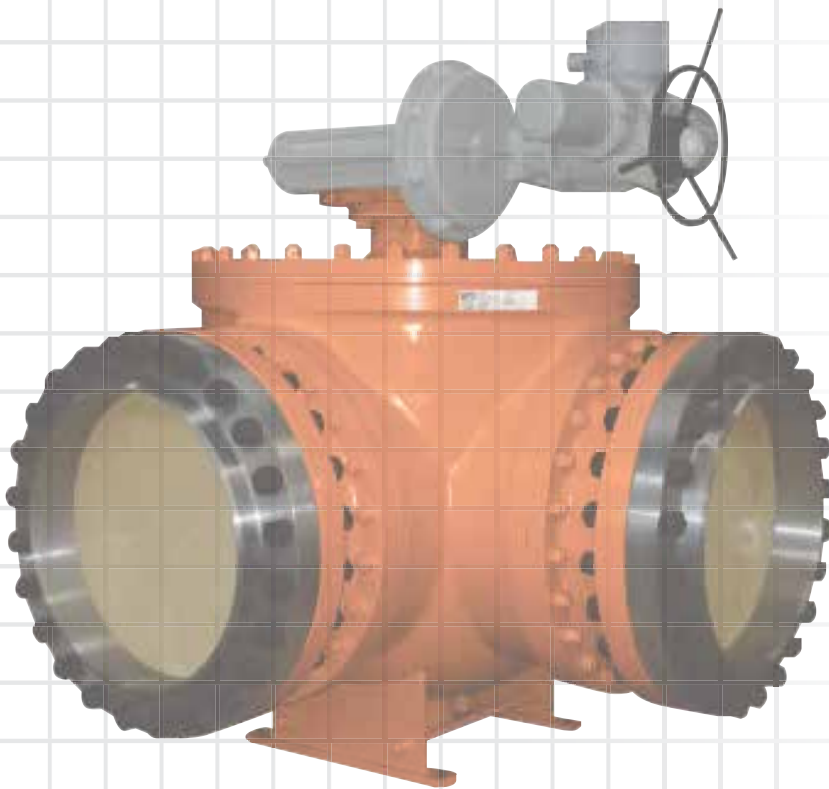

**AUSTRALIAN  
PIPELINE VALVE®**

70-78 Stanbel Road Salisbury Plain South Australia 5109  
Telephone +61 (0)8 8285 0033 Fax +61 (0)8 8285 0044  
email: [admin@australianpipelinevalve.com.au](mailto:admin@australianpipelinevalve.com.au)

[www.australianpipelinevalve.com.au](http://www.australianpipelinevalve.com.au)

## CONTENTS - SHORT VERSION\*

Spring Return Deadman Handle KI Series	4
Spring Return Deadman Handle 76-500 Series	5~6*
Spring Return Deadman Handle High Cycle S-76-K-L20H Series	7
Spring Return Deadman Handle Quarter Turn S71 Series	8
Spring Return Deadman Handle Quarter Turn S71-510-00	9
Spring Return Deadman Handle DH-HT Series	10*
Fusible Link Emergency Shutdown Quarter Turn Valves	11
Multiway Side Entry Unibody SL8141-1P	12~13*
4-Way Double L Port Ball Valves SL8141-KI	14*
Multiway Side Entry Unibody SL8142-FZ	15~16*
Multiway Side Entry 2 Piece SL9141	17~18*
Multiway Flanged Ball Valve BV-509 Series	19
Multiway Ball Valve BV-509 L5U	20~21
Multiway Flanged End Ball Valve BV-509A Series	22
Multiway Screwed Ends Ball Valve BV-TC810LC Series	23*
Multiway Side Entry Spooled Body Ball Valve BV-501T-Z-I	24~25*
Multiway Screwed / Weld End Ball Valve BV-505 Series	26*
Multiway Screwed End Ball Valve (Standard Port) BV-2057 / BV-L50~L54 Series	27~28
Multiway Screwed End Ball Valve (Full Port) L230-KV Series	29~30*
Multiway Screwed End Brass Ball Valve 3L3200 Series	31*

\* This version excludes some of these pages, refer to full version at website.



© Copyright Australian Pipeline Valve 1990 - 2020 Edition

Catalogues, photos, brochures and technical publications are the exclusive property of Australian Pipeline Valve. Any unauthorised reproduction in total or in part, shall result in prosecution. Products and data sheets in this publication are subject to change at anytime without notice. Australian Pipeline Valve reserves the right to carry out amendments to products and materials.

# DEADMAN SPRING RETURN BALL VALVE (FULL PORT) S-76-500 SERIES

## FEATURES

- Full Port
- Spring Return Handle
- Investment Cast Body
- Blow Out Proof Stem/ Floating Ball
- Adjustable Packing Gland
- 150 PSI Saturated Steam
- Working Pressure 13789 kPa (2000PSI) WOG
- Threads Conform to ANSI B1.20.1, BS21, DIN259/2999
- Also available in 3 piece body
- Also available in 3000 PSI, 3700 PSI
- Available in BSP or NPT ends
- Available in Bronze, SS & Carbon Steel



## MATERIALS LIST

No.	Part Name	Material
1	Body	A351-CF8M A216-WCB
2	End Cap	A351-CF8M A216-WCB
3	Ball	ASTM A351 Gr. CF8M
4	Ball Seat	RPTFE
5	Body Seal	PTFE
6	Stem	A276 TYPE 316
7	Thrust Washer	RPTFE
8	Stem Packing	RPTFE
9	Gland Nut	SUS 304
10	Stem Washer	SUS 304
11	Stem Nut	SUS 304
12	Handle Head	A351 - CF8 & SS 304
13	Bolt	SUS 304
14	Handle Flange	A351 - CF8
15	Handle Sleeve	VINYL
16	Handle Bolt	SUS 304
17	Spring	55CrSi
18	Spring Rod	SUS SS304/316
19	Spring Rod Binder	SS304
20	Tube Handle	SS304
21	Tension Adjustment Washer	SS304
22	Hex Nut	SS304

Test Pressure	
Shell Test (Water)	3000PSI
Seat Test (Water)	2200PSI
Seat Test (Air)	80PSI

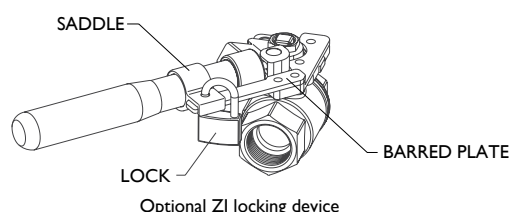
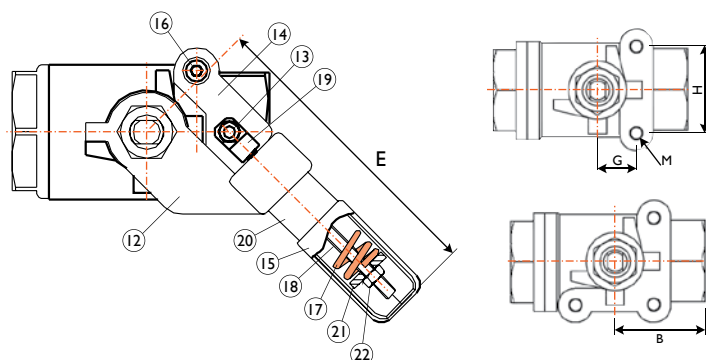
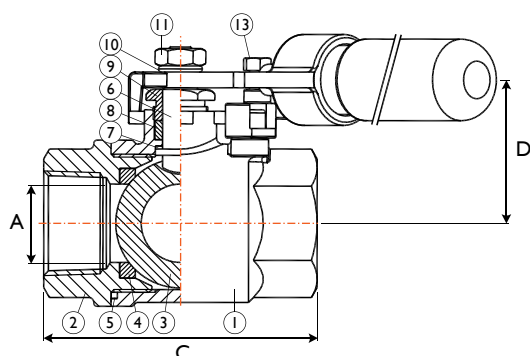

## DIMENSIONS

Size		A		B		C		D		E	
in	mm	in	mm	in	mm	in	mm	in	mm	in	mm
1/4"	8	0.377	9.6	1.122	28.5	2.244	57.0	1.161	29.5	7.244	184
3/8"	10	0.492	12.5	1.122	28.5	2.244	57.0	1.161	29.5	7.244	184
1/2"	15	0.59	15	1.301	33.05	2.602	66.1	1.287	32.7	7.244	184
3/4"	20	0.787	20	1.488	37.8	2.976	75.6	1.440	36.6	7.244	184
1"	25	0.984	25	1.716	43.6	3.433	87.2	1.779	45.2	9.212	234
1-1/4"	32	1.259	32	1.909	48.5	3.818	97.0	2.106	53.5	12.920	330
1-1/2"	40	1.496	38	2.283	56.6	4.456	113.2	2.342	59.5	12.920	330
2"	50	1.968	50	2.637	67.0	5.275	134.0	2.807	71.3	12.920	330

Available up to 100NB (4").

## PRESSURE TEMPERATURE RATING

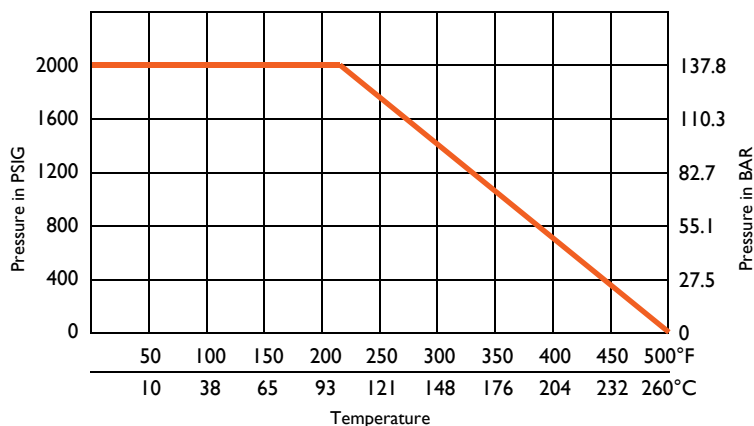

# DEADMAN SPRING RETURN BALL VALVE HIGH CYCLE S-76-K-L20H

## FEATURES

- High Cycle Triple Barrier Stem Seal System
- V-Type Packing for Maximum Stem Sealing
- Belleville Washer Design for Automatic Compression of Stem Sealing
- Full Port DN 8NB~80NB (1/4" - 3")
- Direct Mount Pad (ISO 5211)
- TA Luft Fugitive Emission Compliant
- Spring Return Handle (Dead Man Handle) for Auto Default Position
- 2000PSI (13790 kPa) for 25NB  
1500PSI (10342 kPa) for 32~80NB
- Precision Investment Heavy Hex 2 Piece Cast Body
- Blow-Out Proof Stem
- Available in Carbon Steel or Stainless Steel
- Various End Connections Available (NPT, BSP, ISO 7/11/ ISO 228/1, BW, etc.)



## MATERIALS LIST

No.	Part Name	Quantity	Material
1	Handle Head	1	SUS304/CF8
2	Anchor	1	SUS304/CF8
3	Shaft Bolt	1	SUS304
4	Spring Shaft	1	SUS304/SUS316
4A	Spring Rod Anchor	1	SUS304
5	Spring	1	55CrSi/SUS301
6	Handle	1	SUS304
7	Sleeve	1	PVC
8	Tension Adjustment Washer	1	SUS304
9	Hex Nut	1	SUS304
10	Hex Nuts	2	SUS304
11	Stem Washer	1	SUS304
12	Stem Bolt	1	SUS304
13	Body	1	CF8M
14	Cap	1	CF8M
15	Ball	1	SUS316
16	Seat	2	PTFE
17	Body Gasket	1	PTFE
18	Primary Stem Seal	1	PTFE
19	O-Ring	1	Viton
20	Stem	1	SUS316
21	Stem Packing Set	2 or 4	PTFE V-Rings
22	Gland	1	SUS304
23	Belleville Washer	2	SUS301
24	Disc Plate	1	SUS304
25	Spring Fixture Pad		SUS304
26	Bolt	1	SUS304
27	Stop Bolt	1	SUS304
28	Antistatic Device	1	SUS316

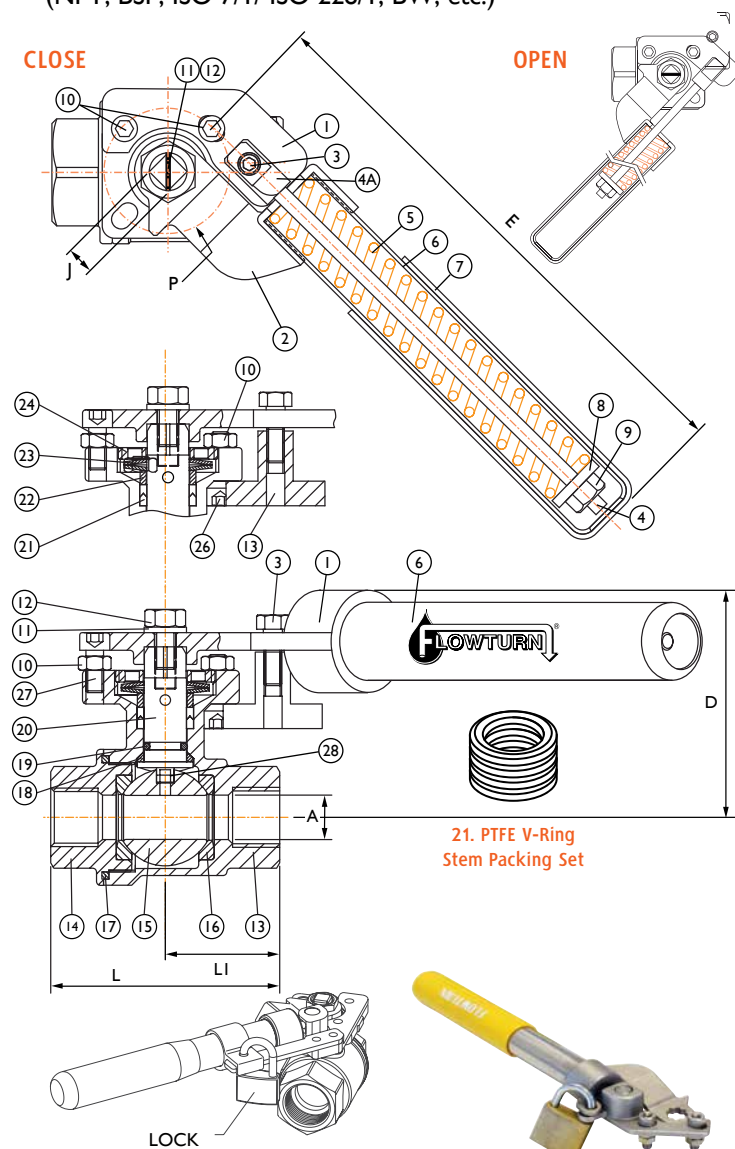

## DIMENSIONS

(MM)

Size	8	10	15	20	25	32	40	50	65	80
	1/4"	3/8"	1/2"	3/4"	1"	1-1/4"	1-1/2"	2"	2-1/2"	3"
A	11.5	12.7	15.0	20.0	25.0	32.0	38.1	50.0	63.5	80.0
h	7.0	7.0	7.0	8.0	11.0	11.0	14.0	14.0	17.0	17.0
H	42	42	42	45	52	57	68	77	99	111
L	65	65	75	80	90	110	120	140	185	205
L1	32.5	32.5	37.5	40.0	10.0	55.0	60.0	70.0	62.5	102.5
J**	9	9	9	9	11	11	14	14	17	17
T	9	9	9	9	10	10	13	13	13	13
D*										
E*										

\* Deadman lever selection requires sizing according to fluid, pressure, temperature and safety factor.

## HANDLE DIMENSIONS & TORQUE

Kit Part No.	E	J**	P (ISO 5211)	Torque
S71-504-00-Z	170	9	F03/F04	15Nm
S71-507-00-Z	207	9	F03/F04	20Nm
S71-507-01-Z	220	11	F04/F05	20Nm
S71-508-00-Z	275	11	F04/F05	30Nm
S71-508-01-Z	280	14	F05/F07	30Nm
S71-509-01-Z	450	14	F05/F07	55Nm

\*\*Available unmounted

Locking device  
This catalogue is general in it's nature and design and can vary at any time. This catalogue is to be used as a guide only.

# SPRING RETURN DEADMAN HANDLE FOR QUARTER TURN VALVES S71(-Z) SERIES (KITS)

## FEATURES

- All components of lever are stainless steel
- Operating torque should be sized according to valve torque, media, pressure and safety.
- Can be fitted on 1P, 2P, 3P valve
- Available in ISO F03 to F07
- 55CrSi Spring Material



OPEN

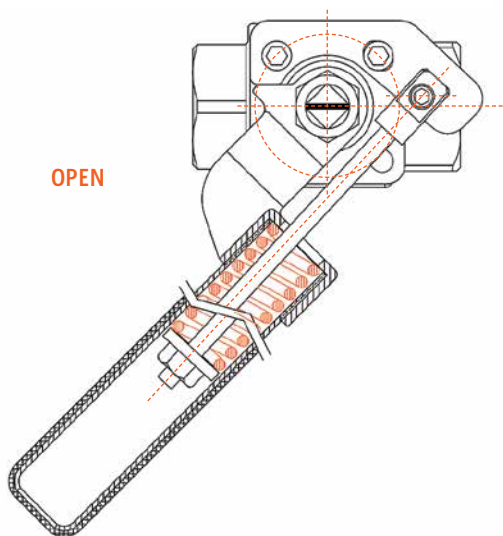

CLOSE

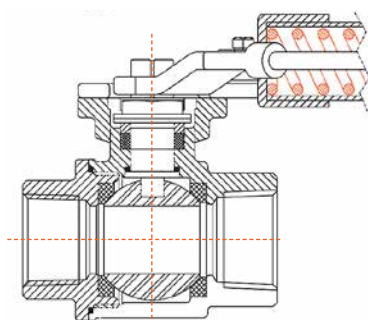
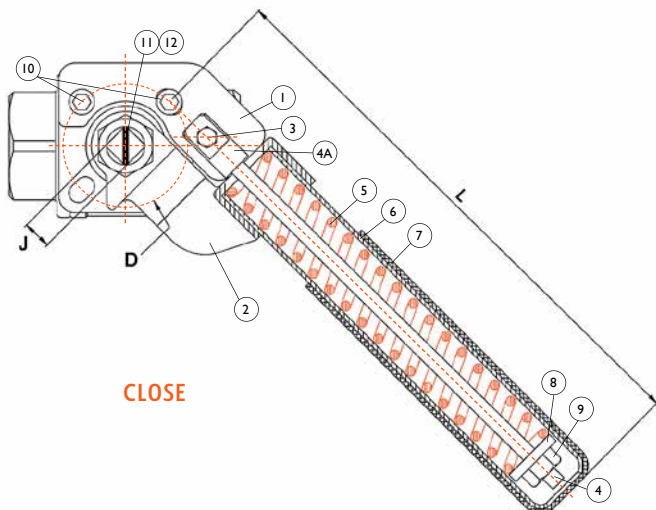

## MATERIALS LIST

Item	Part Name	Quantity	Materials
1	Handle Head	1	CF8
2	Anchor	1	CF8
3	Anchor Screw	1	SS 304
4	Spring Rod	1	SS 304
4A	Spring Rod Anchor	1	SS 304
5	Spring	1	SS 301
6	Handle Extension	1	SS 304
7	Sleeve	1	PVC
8	Washer	2	SS 304
9	Hex Nut	2	SS 304
10	Socket Head Screws	2	SS 304
11	Washer	1	SS 304
12	Nut	1	SS 304

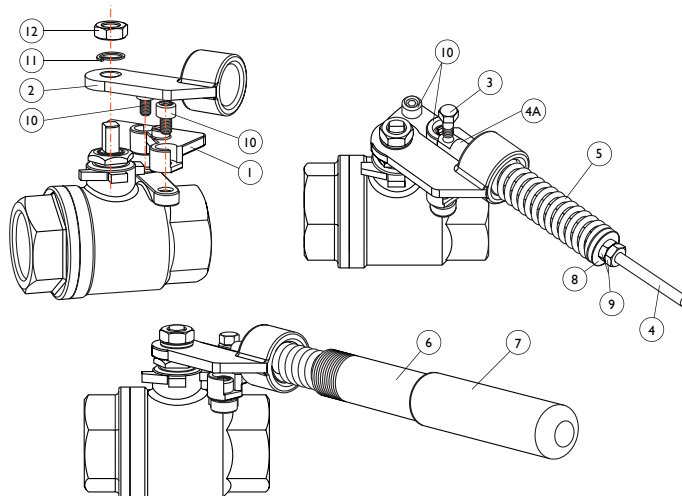

## DIMENSIONS & TORQUE

Kit Part No.	L	J*	D (ISO 5211)	Torque
S71-504-00-Z	170	9	F03/F04	15Nm
S71-507-00-Z	207	9	F03/F04	20Nm
S71-507-01-Z	220	11	F04/F05	20Nm
S71-508-00-Z	275	11	F04/F05	30Nm
S71-508-01-Z	280	14	F05/F07	30Nm
S71-509-01-Z	450	14	F05/F07	55Nm

\*Available unmachined

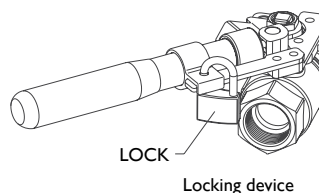

## SPRING RETURN DEADMAN HANDLE FOR QUARTER TURN VALVES MODEL S71-510-00

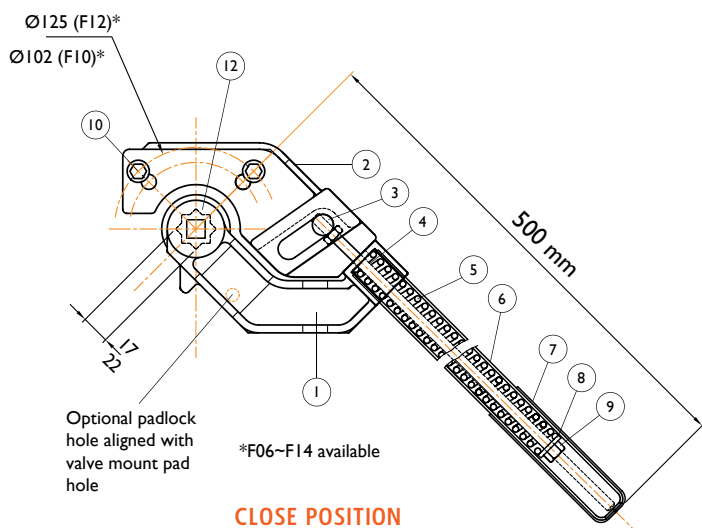

### FEATURES

- All components of lever are stainless steel
- Operating torque should be sized according to valve torque, media, pressure and safety.
- Can be fitted on IP, 2P, 3P valve
- Available in ISO F06 to F14
- 60Si2MN Spring Material

### SIDE VIEW

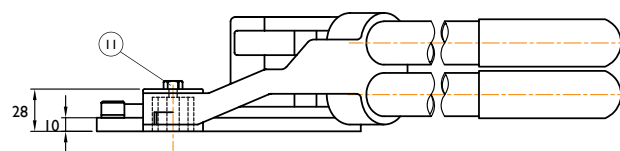

**Maximum Torque 100NM**

(Up to 300Nm available. Refer to KI Series page 4.)

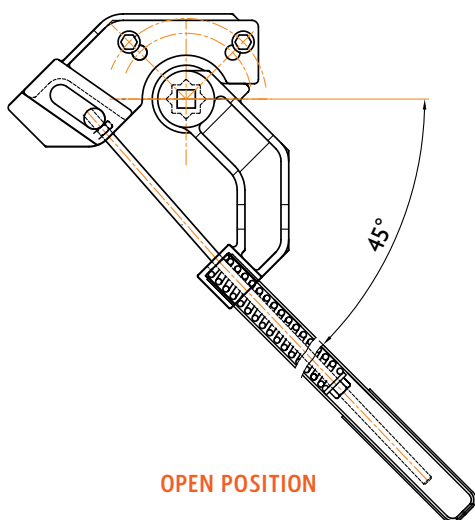

### MATERIALS LIST

Item	Part Name	Materials	Qty
1	Handle Head	CF8 (304)	1
2	Anchor	CF8 (304)	1
3	Rotary Shaft	SS304	1
4	Spring Rod	SS304	2
5	Spring	60Si2MN Spring Steel	2
6	Handle Extension	SS304	2
7	Sleeve	PVC	2
8	Washer	SS304	2
9	Adjustable Hex Nut	SS304	2
10	Socket Head Screw	SS304	2
11	Hex Bolt	SS304	1
12	Drive Bush 17mm ID Square	SS304	1

## FUSIBLE LINK EMERGENCY SHUTDOWN QUARTER TURN VALVES

Valves designed with fire control in mind are crucial to any piping system carrying flammable fluids or gases. Our spring actuated assemblies are designed to fail-close when a fire breaks out, halting the flow which may be adding to or compounding the fire intensity. Valves on the deluge system can be activated to fail-open when heat is sensed, immediately flooding the area with water.

Our fusible link assembly provides the ideal fire protection solution. Designed to melt when environmental heat reaches a predetermined setting, the fusible link separates and allows the spring to drive the valve into the fail-open or fail-closed position. The fire sensitive unit mounts directly onto a quarter turn valve and can be manually operated when required. Unless specified otherwise, spring assemblies will be furnished for spring-to-close operation.

The spring module is completely enclosed for maximum safety and the fusible link is mounted externally for environmental sensitivity. The spring actuated assemblies can be retrofitted to many existing valves and are fully field-adjustable. Optional limit switches are available for remote indication of open or closed positions. Typical applications for these units can be found in paint plants, chemical, or hydrocarbon processing facilities.



Shuts down in event of fire. Fusible link for quick quarter-turn operation in fail-safe valve positioning (fail-closed positioning).



A temperature sensitive valve actuator with a self-contained energy source, for automatic valve operation in the event of a fire (fail-closed positioning).

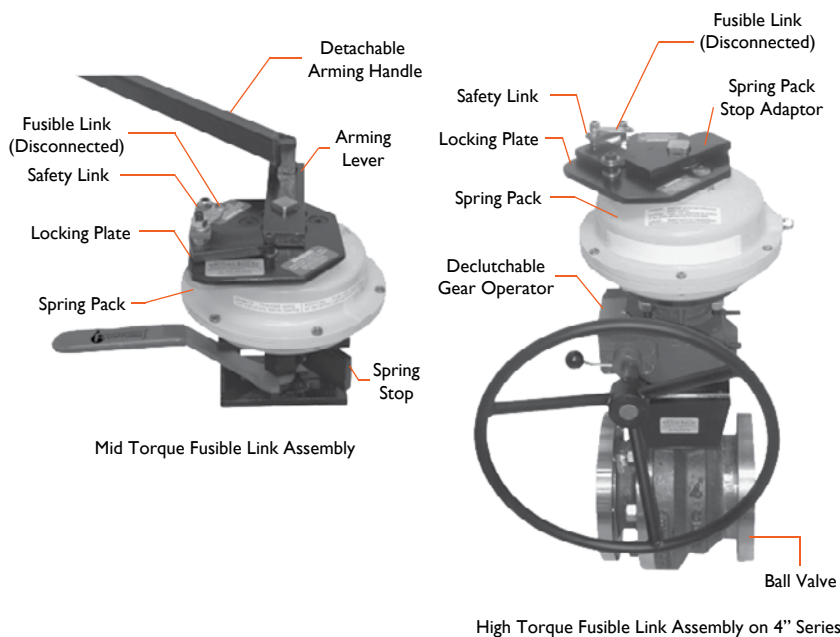

ESDV - Swing Check Valve with UL/FM approved fusible link.  
See page 7 of Flowturn Gate, Globe, Check Catalogue.

# MULTIWAY SIDE ENTRY SPOOLED BODY BALL VALVE BV-509 SERIES

## MODEL BV-509

- Full Port
- Available in T-port, L-port, 3-way, 4-way, 5-way configuration.
- For food and general chemical service applications
- Self-adjusting stem packing
- Blow-out-proof stem design
- ISO 5211 actuator mounting pad on request.
- In-line repairable
- 90-degree handle movement, or 180-degree when specified.
- Carbon or stainless steel body construction
- Hydrostatic test pressure per API 598

## SPECIFICATIONS

- Working Pressure: PN 10/16/25/40/60  
150lbs, 300lbs, 600lbs, 900lbs  
(Higher rating on request)
- Temperature Range: -40 to 232°C (-40 to 450°F)
- Flange Dimension: ISO (DIN) PN10/16 & PN25/40  
ANSI 150lbs, 300lbs, 600lbs, 900lbs

L-PORT



T-PORT



BV-509 DN15~50 (1/2"-2")



BV-509-DE DN15~50 (1/2"-2")  
(600lbs, 900lbs)

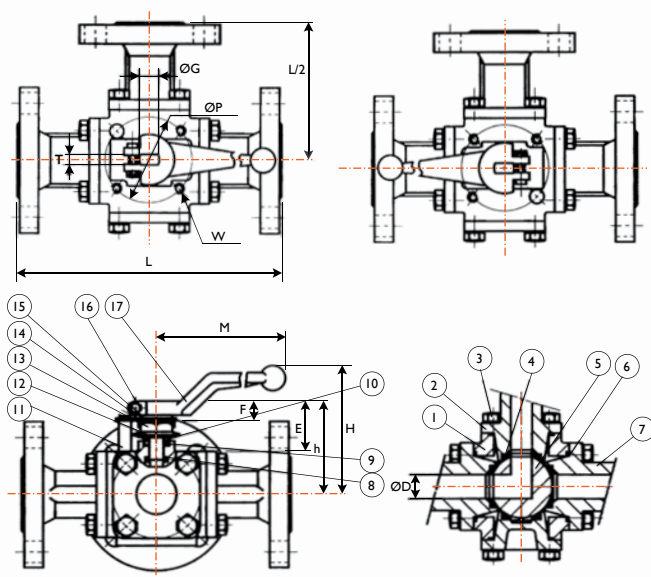

## DIMENSIONS BV-509 (MM)

Size		D	H	M	P	W	G	T	h	E	F	L				Torque NM
in	mm											PN16	PN40	ANSI 150	ANSI 300	
1/2"	15	15.5	65	145	50	M6	M10	6.5	51.5	25	11	160	160	152	162	150
3/4"	20	20	70	165	50	M6	M12	8	55.5	26	11	177	177	167	179	200
1	25	25	75	195	70	M8	M14	9.7	69	36	15	191	191	185	196	300
1-1/4"	32	32	90	250	70	M8	M18	12	89.5	51	25	209	209	201	207	450
1-1/2"	40	38	95	250	102	M10	M18	12	98.5	51.5	25	234	234	145/220	224	650
2"	50	50	130	340	102	M10	M24	15	120	61	28	273	273	202/253	259/270	900

DN65~300 (2 1/2" - 12") refer to separate drawing. ANSI 600 to 900 Class, refer to drawing.

## MATERIALS LIST

Item	Part Name	Standard Material	Qty
1	Body	ASTM A351 Gr. CF8M	1
2	End	ASTM A351 Gr. CF8M	1
3	Bolts, Spring Washers	SS304	16-20
4	Ball Seats	PTFE + 15% Glass Fibre	4-5
5	Ball	SS316	1
6	Gaskets	PTFE	1
7	End Caps	ASTM A351 Gr. CF8M	3-5
8	Thrust Washer	PTFE + 15% Carbon Fibre	1
9	Stem Packing	PTFE	1 set
10	Gland	SS304	1
11	Stopper	SS304	1
12	Packing Spring	SS301	1 set
13	Stem Nut	SS304	1
14	Nut Stop	SS304	1
15	Plate Stop	SS304	1
16	Bolt, Nut	SS304	1
17	Handle	SS304	1

2 1/2" - 12" (DN65~300). Refer to separate drawing.

## PRESSURE / TEMPERATURE

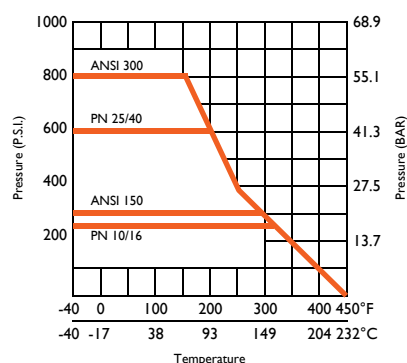

# MULTIWAY SIDE ENTRY SPOOLED BODY BALL VALVE BV-509-L5U SERIES

## MODEL BV-509-KI

- Full Port
- High Cycle triple barrier stem seal system
- Available in T-port, L-port, 3-way, 4-way, 5-way configuration.
- Four seats
- Self-adjusting stem packing
- Blow-out-proof stem design
- Direct ISO 5211 actuator mounting pad.
- 90-degree handle movement, or 180-degree when specified.
- Carbon or stainless steel body construction
- Hydrostatic/Pneumatic test pressure per API 598

## SPECIFICATIONS

- Working Pressure:  
PN 10/16/25/40  
150lbs, 300lbs
- Temperature Range:  
-40 to 232°C (-40 to 450°F)
- Flange Dimension:  
ISO PN10/16 & PN25/40  
ANSI 150lbs, 300lbs



BV-509-L5U DN15~50 (1/2"-2")



BV-509-L5U DN65~100 (2-1/2"-4")



BV-509-L5U DN125~200 (5"-8")

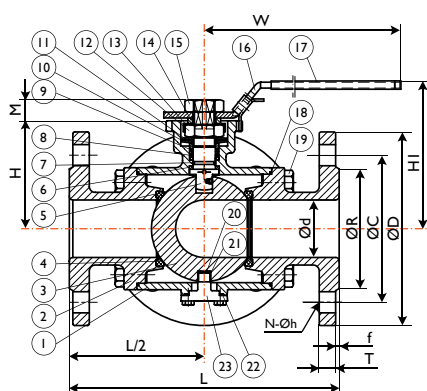

15NB~50NB

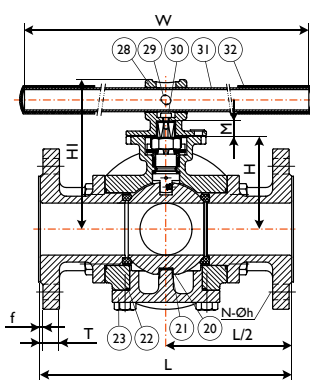

65NB~100NB

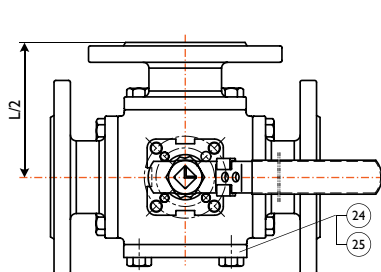

125NB~200NB (Gear operated)

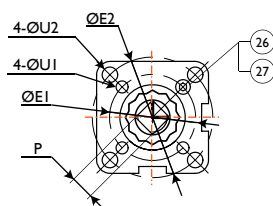

Direct Mount Pad (ISO 5211)

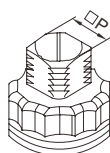

## MATERIALS LIST

No.	Part Name	Material		
1	Body	CF8M	CF8	WCB
2	End Cap (1)	CF8M	CF8	WCB
3	Ball	CF8M	CF8	
4	Ball Seat	PTFE/TFM1600		
5	Stem	316	304	
6	Thrust Washer	PTFE		
7	O-Ring	FKM		
8	Packing	PTFE/Grafoil		
9	Bushing	50%SS+50%PTFE/304		
10	Gland	316		
11	Belleville Washer	301		
12	Stem Nut	A194-8		
13	Stop-lock-cap	304		
14	Handle Gland	304		
15	Handle Nut	304		
16	Handle + Lock Device	304		
17	Handle Sleeve	Vinyl Plastic		
18	Body Gasket (1)	PTFE/Grafoil		
19	Bolting	A193-B8		A193-B7
20	Washer	PTFE		
21	Jacket	PTFE		
22	Body Gasket (2)	PTFE/Grafoil		
23	Bottom Cap	CF8M	CF8	WCB
24	End Cap (2)	CF8M	CF8	WCB
25	Body Gasket (3)	PTFE/Grafoil		
26	Stop Bolt	A2-70		
27	Stop Nut	A2-70		
28	Handle Adapter	CF8		
29	Set Screwed	A2-70		
30	Bolting	A2-70		
31	Pipe Handle	A53+Plated Zn		
32	Handle Sleeve	Vinyl Plastic		

For 125~300 NB refer to separate drawing.

## BV-509-L5U SERIES

### DIMENSIONS BV-509-L5U CLASS 150

(MM)

Size		d	L	R	D	C	T	f	N	h	H	H1	W	P	M	E1	E2	U1	U2	ISO 5211
in	mm																			
1/2"	15	15	150	35.0	90	60.3	8.0	2	4	16.0	53.0	83	147	9	9	36	42	6	6	F03~F04
3/4"	20	20	165	43.0	100	69.9	8.9	2	4	16.0	57.0	87	147	9	9	36	50	6	7	F03~F05
1"	25	25	181	51.0	110	79.4	9.6	2	4	16.0	68.0	99	177	11	11	42	50	6	7	F04~F05
1-1/4"	32	32	190	63.5	115	88.9	11.2	2	4	16.0	72.0	103	177	11	11	42	70	6	9	F04~F07
1-1/2"	40	38	212	73.0	125	98.4	12.7	2	4	16.0	85.0	119	197	14	14	50	70	7	9	F05~F07
2"	50	49	229	92.0	150	120.7	14.3	2	4	19.0	92.0	126	197	14	14	50	70	7	9	F05~F07
2-1/2"	65	60	290	105.0	180	139.7	15.9	2	4	19.0	107.0	172	400	17	17	70	102	9	11	F07~F10
3"	80	75	310	127.0	190	152.4	17.5	2	4	19.0	119.0	185	400	17	17	70	102	9	11	F07~F10
4"	100	99	367	157.0	230	190.5	22.3	2	8	19.0	150.0	221	400	22	22	-	102	-	11	F10
5"	125	125	460	186.0	255	215.9	22.3	2	8	22.3	215.0	-	-	36	36	140	165	18	22	F14~F16
6"	150	150	490	216.0	280	241.3	23.9	2	8	22.3	228.5	-	-	36	36	140	165	18	22	F14~F16
8"	200	200	620	270.0	345	298.5	27.0	2	8	22.3	281.5	-	-	36	36	140	165	18	22	F14~F16

### DIMENSIONS BV-509-L5U CLASS 300

(MM)

Size		d	L	R	D	C	T	f	N	h	H	H1	W	P	M	E1	E2	U1	U2	ISO 5211
in	mm																			
1/2"	15	15	150	35.0	95	66.7	12.7	2	4	16.0	53.0	83	147	9	9	36	42	6	6	F03~F04
3/4"	20	20	165	43.0	115	82.6	14.3	2	4	19.0	57.0	87	147	9	9	36	50	6	7	F03~F05
1"	25	25	181	51.0	125	88.9	15.9	2	4	19.0	68.0	99	177	11	11	42	50	6	7	F04~F05
1-1/4"	32	32	207	63.5	135	98.4	17.5	2	4	19.0	72.0	103	177	11	11	42	70	6	9	F04~F07
1-1/2"	40	38	234	73.2	155	114.3	19.1	2	4	22.3	85.0	119	197	14	14	50	70	7	9	F05~F07
2"	50	49	258	92.0	165	127.0	20.7	2	8	19.0	92.0	126	197	14	14	50	70	7	9	F05~F07
2-1/2"	65	60	316	104.7	190	149.2	23.9	2	8	22.3	107.0	172	400	17	17	70	102	9	11	F07~F10
3"	80	75	360	127.0	210	168.3	27.0	2	8	22.3	119.0	185	400	17	17	70	102	9	11	F07~F10
4"	100	99	398	157.0	255	200.0	30.2	2	8	22.3	150.0	221	400	22	22	-	102	-	11	F10
5"	125	125	480	186.0	280	235.0	33.4	2	8	22.3	215.0	-	-	36	36	140	165	18	22	F14~F16
6"	150	150	520	216.0	320	269.9	35.0	2	12	22.3	228.5	-	-	36	36	140	165	18	22	F14~F16
8"	200	200	660	270.0	380	330.2	39.7	2	12	25.4	281.5	-	-	36	36	140	165	18	22	F14~F16

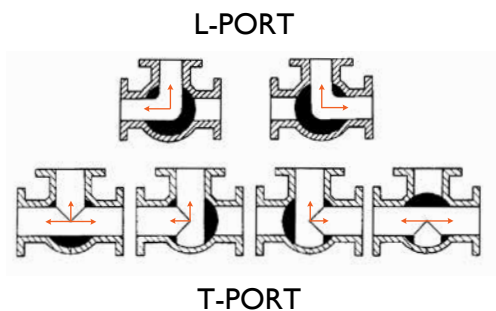

### PRESSURE / TEMPERATURE

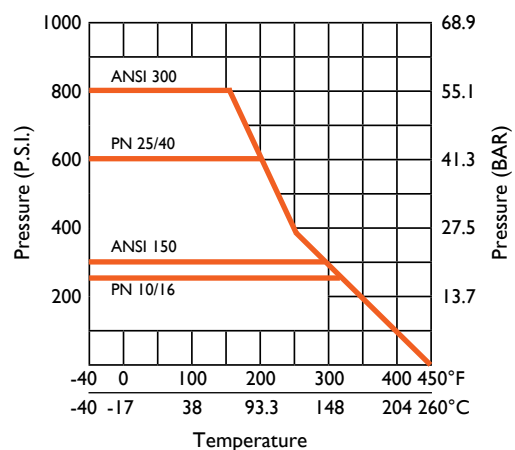

# MULTIWAY SPOOLED BODY BALL VALVE BV-509A SERIES

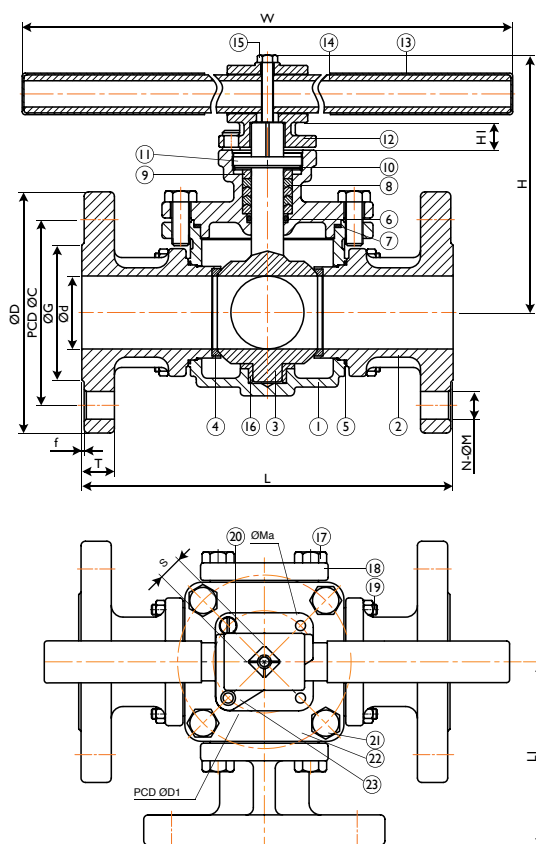



## BILL OF MATERIALS

Item	Parts	Material		
1	Body	ASTM A351-CF8M	ASTM A351-CF8	ASTM A216-WCB
2	Cap			ASTM A351-CF8M
3	Ball & Stem			ASTM A351-CF8M
4	Seat	RPTFE		
5	Gasket	PTFE		
6	O-Ring	Viton		
7	Gasket	PTFE		
8	Packing	PTFE		
9	Gland Ring	SUS 304		
10	Spring Washer	SUS 301		
11	Cap-C	ASTM A351-CF8M	ASTM A351-CF8	
12	Handle Head	ASTM A351-CF8		
13	Handle Sleeve	Plastic		
14	Handle Pole	Galvanised Pipe		
15	Handle Bolt	SUS 304		
16	Sleeve	PTFE/RTFE		
17	Cap-B Bolt	SUS 304		Carbon Steel
18	Cap-B	ASTM A351-CF8M	ASTM A351-CF8	ASTM A216-WCB
19	Bolt	SUS 304		Carbon Steel
20	Stop Pin			SUS 304
21	Cap-A Bolt			Carbon Steel
22	Cap-A	ASTM A351-CF8M	ASTM A351-CF8	ASTM A216-WCB
23	Lock Device	SUS 304		

## FEATURES:

End Flange Dimension: ASME B16.5  
 Design: ASME B16.34  
 Investment Cast Body  
 ISO 5211 Mounting Pad  
 Trunnion Mount / Full Port  
 90° degree turn operation. Four seats  
 L-Port or T-Port available / 360° Pad

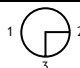
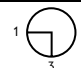
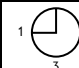
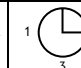
## FLOW PATTERN:

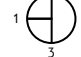
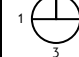
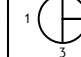
PORT TYPE	1	2	3	4
L				
T				

## DIMENSIONS 150LB

Size		d	G	C	D	L	L1	H	H1	W	T	f	S	D1	N	M	Ma	Weight (Kg)		Torque (N-m)
in	mm																	L-Port	T-Port	
1-1/4"	32	32	64	89	117	221	110.5	171	19	403	12.7	1.6	17	70	4	16	10	-	-	71.5
1-1/2"	40	40	73	98.5	127	221	110.5	171	19	403	14.3	1.6	17	70	4	16	10	12.8	12.6	71.5
2"	50	50	92	120.5	152	254	127	176	19	403	15.9	1.6	17	70	4	19	10	16.3	16.2	104
2-1/2"	65	65	105	139.5	178	300	150	208	24	504	17.5	1.6	22	102	4	19	12	27.6	26.5	156
3"	80	76	127	152.5	190	305	152.5	216	24	504	19.1	1.6	22	102	4	19	12	34	33.9	234
4"	100	96	157	190.5	229	369	184.5	236	24	504	23.9	1.6	22	102	8	19	12	63.4	61.9	286
6"	150	148	216	241.5	279	480	240	329	38	800	25.4	1.6	36	140	8	22	18	151	147.5	494
8"	200	200	270	298.5	343	630	315	354	40	1000	28.6	1.6	36	140	8	22	18	274.4	270.4	715

## MULTIWAY SCREWED END BALL VALVE (STANDARD PORT) BV-2057/L50~L54 SERIES



BV2057 (Standard Mount Pad)

### MODEL BV-2058/

Flowturn 3-way valves provide lateral diverting flow from a common inlet to either side exit with a quarter turn, alternatively diverting flow from a single source to two different lines. The valve is a Transflow-Diverting type, so the possibility of completely stopping flow during port positioning is eliminated. However, this also means probable product mixing during a portion of the port change. Care must be taken at a blocked port not to exceed that of the flowing media by more than 1723 kPa (250 psi), or temperature at the blocked port not to exceed flowing media more than 93°C (200°F). The valves are designed for flow either into or out of the common side port. These valves are 90 degree turn, side entry, available in reduced and full port.



BV-L50~L54 (Direct Mount Pad)

### FEATURES

- Threaded ends conform to ASME B1.20.1 (NPT) DIN 2999 & BS 21 ISO 228/1 & ISO 7/1 & BSPT
- Investment casting
- Blow-out proof stem
- Standard port (Full bore on request)
- 6890 kPa (1000 psi) W.O.G.
- PTFE reinforced seat, seal, packing
- Mounting pad tapping
- L port
- T port
- Locking Device
- Anti-static device (option)
- ISO 5211 Direct mounting pad (option)



Deadman Lever option (Spring Return)

### PRESSURE TEMPERATURE RATING

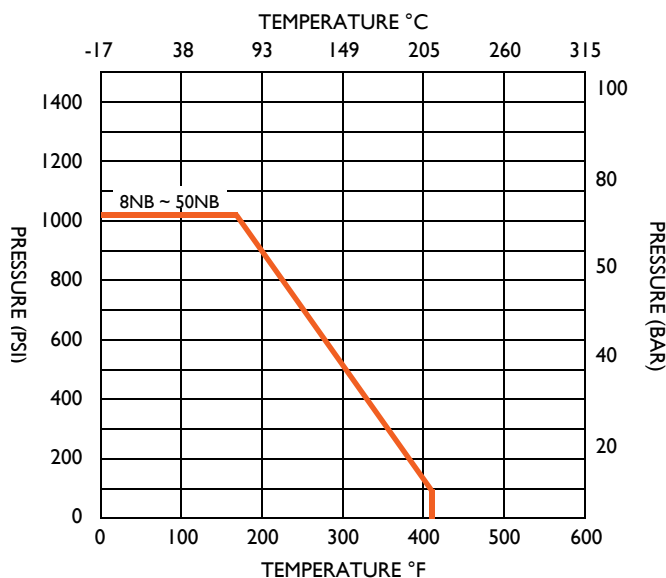

## MODEL BV-2057/BV-L50/53

### DIMENSIONS

Size		d	L	L1	H	W	S	S1	H1	E	Ra	Rb	Torque (N-M)
mm	in												
8	1/4	11.6	76	58.5	73	123	36	42	9	9	3	3	10
10	3/8	12.5	76	58.5	73	123	36	42	9	9	3	3	10
15	1/2	12.5	76	58.5	73	123	36	42	9	9	3	3	10
20	3/4	16	86	72	76	123	36	42	9	9	3	3	15
25	1	20	99	81.5	87	153	42	50	11	11	3	3.5	22
32	1-1/4	25	117	94.5	93	153	42	50	11	11	3	3.5	30
40	1-1/2	32	124	104	110	183	50	70	14	14	3.5	4.5	47
50	2	38	148	125	119	183	50	70	14	14	3.5	4.5	58

### MATERIALS LIST

Item	Parts	Material
1	Body	ASTM A351-CF8M
2	Cap-A	
3	Ball	
4	Seat	PTFE
5	Stem	AISI 316
6	Seal-A	PTFE
7	Thrust Washer	PTFE
7a	Thrust Washer	PEEK or 50%SS+50% PTFE
8	O-Ring	VITON
9	Packing	PTFE
10	Gland	AISI 304
11	Belleville Washer	
12	Stem Nut	
13	Locking Washer	
14	Handle Washer	
15	Locking Device	
16	Handle	
17	Handle Sleeve	PVC
18	Cap-B	ASTM A351-CF8M
19	Seal-B	PTFE
20	Stop Pin	AISI 304

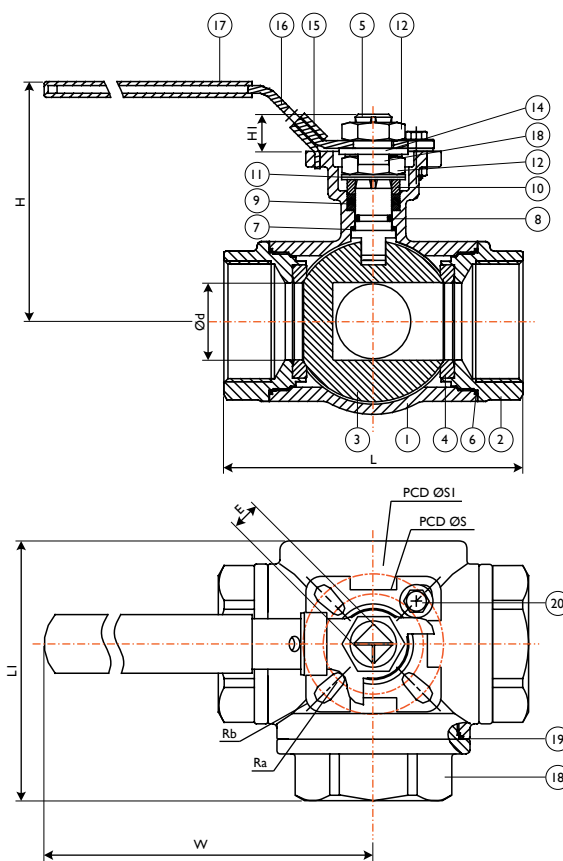

Indicative drawing/s. Bill on materials only for standard port direct mount version.  
Refer to as 'built' drawing.

PORT TYPE	1	2	3	4
L				
T				



**AUSTRALIAN  
PIPELINE VALVE®**

**COMPLETE  
PRODUCT LINE**

**“Australian Pipeline Valve  
produces isolation,  
control and flow reversal  
protection products for  
severe and critical service  
media in utility, steam,  
pipelines, oil & gas  
and process industries.  
APV valves and pipeline  
products form the most  
competitive portfolio  
in the market.”**



**SUPER·CHECK®**



**TORQTURN®**

**TWIN-LOK®**

**UNIFLO®**



## AUSTRALIAN PIPELINE VALVE BRAND RANGE - CATALOGUES

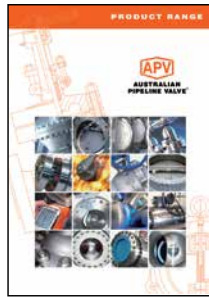

**Product Brochure**



**Ball Valves Floating  
& Trunnion Mounted**



**Ball Valves  
Floating Small Bore**

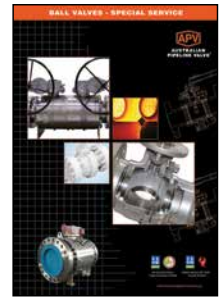

**Ball Valves  
Special Service**



**Gate, Globe & Check  
Valves - Cast Steel**



**Gate, Globe & Check  
Valves - Forged Steel**



**Plug Valves Lubricated,  
Sleeved & Lined**

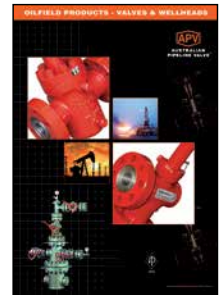

**Oilfield Products  
Valves & Wellheads**

## APV FAMILY OF BRANDS RANGE - CATALOGUES



**Diamond Gear  
Gearboxes**



**Flowturn Ball Valves  
Multiway & Deadman**



**Flowturn Gate, Globe  
& Check Valves**



**Flowturn  
Instrument Valves**



**Flowturn Strainers  
& Sight Glasses**



**Steamco  
Steam Valves**



**Supercheck  
Wafer Check Valves**



**Superseal  
Butterfly Valves**

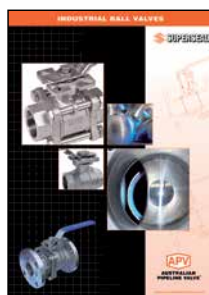

**Superseal  
Industrial Ball Valves**



**Torqturn Actuators**

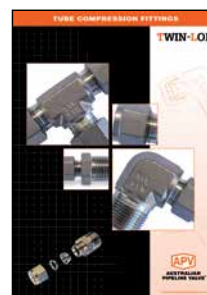

**TwinLok Tube Fittings**



**Uniflo Check Valves**

**Contact us for your local stockist/distributor**

**View our catalogues at [www.australianpipelinevalve.com.au](http://www.australianpipelinevalve.com.au)**

**APV AgentsWanted**

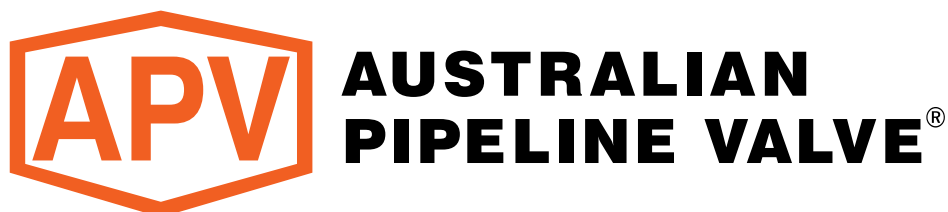

ADELAIDE • BRISBANE • PERTH



[www.australianpipelinevalve.com.au](http://www.australianpipelinevalve.com.au)

LOCAL DISTRIBUTOR



## QUALITY ASSURANCE AND CERTIFICATION

We are continually improving all facets of quality assurance. Full metallurgical and test certificates are always supplied for all pressure retaining parts.

We have endeavoured to provide a broad outline of our range and capabilities. Because we are continually developing new products for our customers this catalogue will, to some extent be incomplete. This catalogue is a general overview only, individual drawings and data sheets can be furnished on request.

If you have any requirement in the field of valves, please contact us for a prompt response. Continuous development of Australian Pipeline Valve products may necessitate changes in the design or manufacturing processes. Australian Pipeline Valve reserves the right to effect any such changes without prior notice.

